

尺寸/Dimensions 单位/Unit=mm

RoHS COMPLIANT

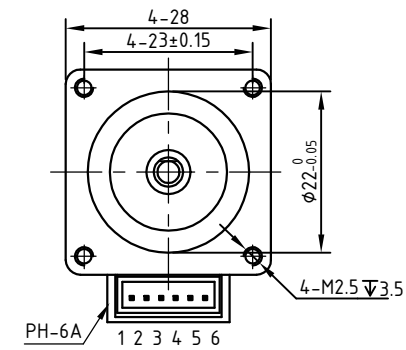

28CM005-D V2.0

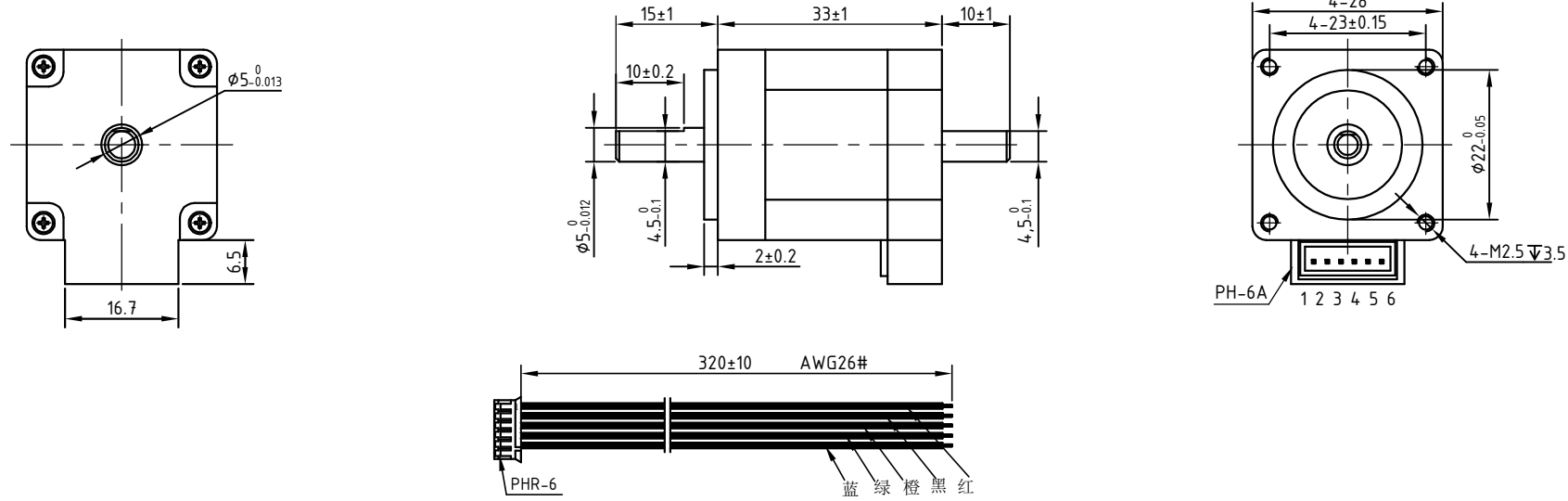

电动机规格书/Motor Specification

相数/Number Of Phase	5
基本步距角/Basic Step Angle	0.72°
基本步距角误差(空载)/Positional Accuracy(no-load)	±0.05°以下/Max
额定电流(相)/Rated Current(Phase)	1.2A
电阻(相)/Resistance(Phase)@20°C	0.65Ω±15%
电感(相)/Inductance(Phase)@1KHz	0.26mH±20%
保持力矩/Holding Torque	0.05N·m
转子惯量/Rotor inertia	≈0.09g·cm²
质量/Mass	Kg
径向跳动(最大)/Radial Play(Max)	0.025mm(Load/负载 450g)
轴向跳动(最大)/Axial Play(Max)	0.075mm(Load/负载 920g)
额定工作状态/Duty	连续/Continuous
绝缘耐压/Dielectric Strength	500V A.C
绝缘电阻/Insulation Resistance	100MΩ Min/500VDC
绝缘等级(UL)/Insulation Class(UL)	B
温升/Temperature Rise	80K以下/Max
使用温度范围/Operation Ambient Temperature	0°C~+50°C
使用湿度范围/Operation Ambient Humidity	20%RH~90%RH
保存温度范围/Storage Ambient Temperature	-20°C~+70°C
保存湿度范围/Storage Ambient Humidity	15%RH~95%RH

接线图/Wiring Diagram

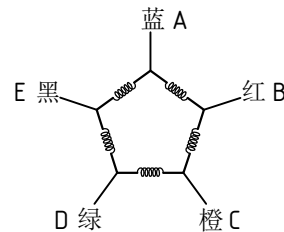

励磁顺序 (5相励磁)  
Phase Sequence(2 Phase Exciting)

铭牌内容/Label Discription

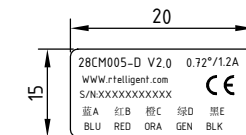

第一角画法  
First Angle View

批准 Approved	材料 Material	公差 Tolerance	±0.2	NO.
审核 Checked	表面处理 Finish	比例 Scale	1:1	页 Sheet
设计 Designed	SHH	25.12.11		1/1
客户	设计 Designed	日期 Date	初版/First Edition	变更内容 Revisions
			版本 Edition	